

REMINGTON®

EST. NEW YORK 1937



The Works Beard Trimmer Kit MB905

 remington-europe.com

Register online for an **EXTRA** year guarantee

Visit uk.remington-europe.com/product-registration You must register within 28 days of purchase.

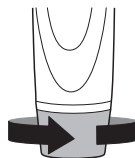
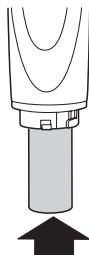
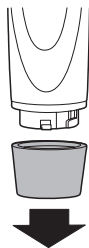
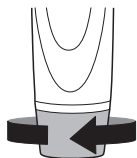
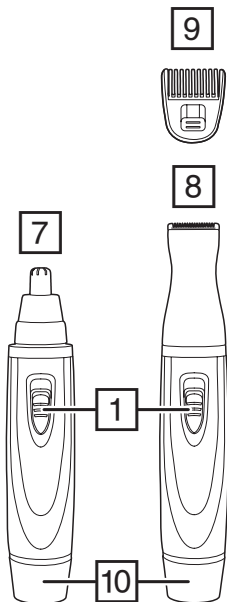
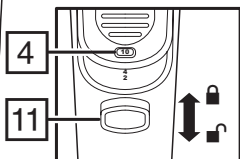
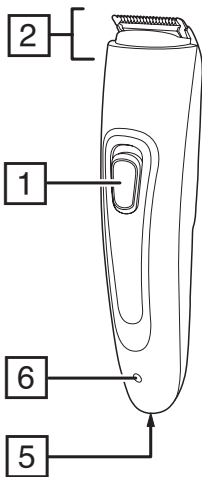
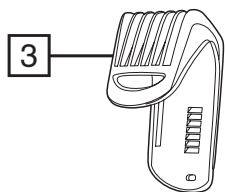

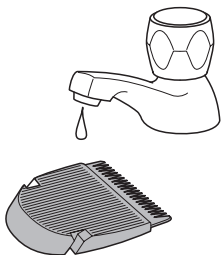
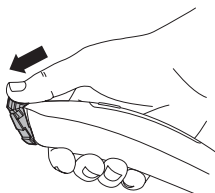
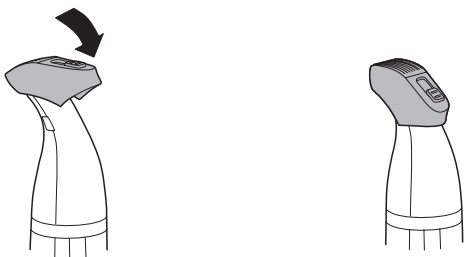
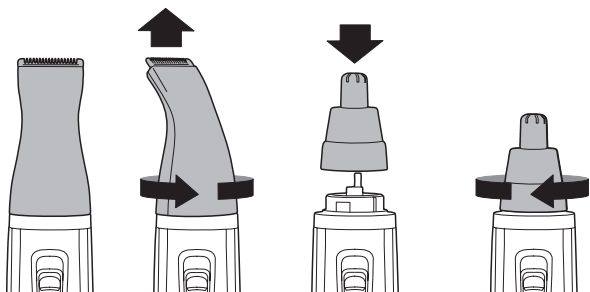

Thank you for buying your new Remington® product. Please read these instructions carefully and keep them safe. Remove all packaging before use.

IMPORTANT SAFEGUARDS

- This appliance can be used by children aged from 8 years and above and persons with reduced physical, sensory or mental capabilities or lack of experience and knowledge if they have been supervised/instructed and understand the hazards involved. Children shall not play with the appliance. Cleaning and user maintenance shall not be done by children unless they are older than 8 and supervised. Keep the appliance and cable out of reach of children under 8 years.
- The body of this appliance is not washable or water resistant. Do not put the appliance in liquid.
- Do not use the product with a damaged cord.
- The battery in the beard trimmer is not replaceable.
- Do not use the appliance if it is damaged or malfunctions.
- This appliance should never be left unattended when plugged into a power outlet, except when charging.
- Keep the power plug and cord away from heated surfaces.
- Do not plug or unplug the appliance with wet hands.
- Do not twist or kink the cable, or wrap it round the appliance.
- This appliance is not intended for commercial or salon use.

BATTERY SAFETY

- Remove batteries if the unit is not in use for long periods.
- It is not recommended to use a rechargeable battery as this can result in poor performance
- Do not try to charge non-rechargeable batteries.
- Different types of batteries or new and used batteries are not to be mixed.
- Do not dispose of used batteries in a fire.
- Do not short circuit the battery contacts.
- Used batteries must be removed from the appliance, recycled or disposed of in an environmentally friendly way (see RECYCLING).

PARTS

- | | |
|-----------------------------------|----------------------------|
| 1. On/off switch | 9. Adjustable stubble comb |
| 2. Main blade | 10. Battery compartment |
| 3. Adjustable beard comb 2 – 18mm | 11. Comb lock |
| 4. Length position indicator | Not Shown: |
| 5. Charger connector | • USB charging cable |
| 6. Charging indicator light | • Beard brush |
| 7. Rotary trimmer | • Storage pouch |
| 8. Precision trimmer | |

GETTING STARTED

CHARGING YOUR BEARD TRIMMER

- It is recommended to fully charge your appliance before using it for the first time.
- Ensure the product is switched off.
- Connect the product to the USB cable and then to the USB end of the cable to a powered USB port.

CHARGING INDICATOR LIGHTS

When charging, the charge indicator will come on. When fully charged the indicator will stay on.

- Run time from fully charged is up to 45 mins.
- Charge time from empty is 16 hours.
- Do not recharge your product after each use as this will shorten the life of the battery.
- Note: To preserve the life of your batteries, let them run out every 6 months then fully charge.

INSTRUCTIONS FOR USE

BEFORE YOU BEGIN

- Comb facial hair with a fine comb before you start trimming.

ATTACHING AND REMOVING THE BEARD COMB

- Make sure that the comb lock is in the down (unlocked) position.
- Slide the comb down the grooves until it clicks into place.
- To remove, make sure that the comb lock is in the down (unlocked) position then slide the comb off the trimmer.

ADJUSTING THE TRIM LENGTH

- The beard comb can be adjusted to give you 9 different trim lengths.
- To adjust, make sure the comb lock is in the down (unlocked) position and slide the comb up or down until the desired length is in the length position indicator window.
- Lock the setting by sliding the comb lock button up to the locked position.
- Use the beard trimmer without the adjustable comb for trimming hair close to the skin. This will trim hair to 1mm, holding the blades perpendicular to the skin will trim hair to 0.4mm.

TO THIN AND TAPER THE BEARD/MOUSTACHE

- Fit the adjustable beard comb.
- Turn the unit on.
- Place the flat top of the trimmer comb against the skin.
- Slowly slide through the hair. Repeat from different directions as necessary.
- If hair builds up in the trimmer comb during the trimming process, switch the unit off, pull off the comb and brush the hair off.

TO DEFINE THE BEARD/MOUSTACHE LINE

- Remove the adjustable beard comb.
- Start with edge of beard/moustache line and gently lower the trimmer blade onto your skin.
- Use motions towards edge of beard/moustache line to trim to desired locations in facial area and away from beard in neck area.

TRIMMING EDGE OF SIDEBURNS

- Remove the adjustable beard comb.
- Start with edge of sideburn and with the trimmer blades resting lightly against your skin, use motions towards edge of sideburn line to trim the desired locations in facial area.

TRIMMING THE NAPE OF YOUR NECK

- Note: You will need a hand mirror for this operation if performing it alone.
- Remove the adjustable beard comb.
- Use your fingers to lift the hair at the base of your head up off the neck. Your index finger should be covering the roots of the hairs you are lifting to prevent accidental removal by trimmer.
- Using your other hand, hold the trimmer to the base of your neck with the cutting unit facing up and move the trimmer up the length of the neck until it touches your finger, covering the hair roots at the base of your head.
- Be sure to move the unit slowly when performing this operation and to keep the hair roots at the base of your head out of the way of the trimmer.

CARE FOR YOUR BEARD TRIMMER

- Your beard trimmer is fitted with high quality blades.
- To ensure long lasting performance of your beard trimmer, clean the blades and body regularly.
- Always keep the attachment guide comb on the trimmer blade.

AFTER EACH USE

- Ensure the appliance is switched off and unplugged from the charger before cleaning.
- Brush the accumulated hair from the blades and body of your beard trimmer. Do not submerge it in water.
- To clean unit, wipe with a damp cloth and dry immediately.
- Place a few drops of cutter or sewing machine oil onto the blades. Wipe off excess oil.

EVERY SIX MONTHS

- Hold the clipper in one hand so that the blades are at the top, place your thumb underneath the blades and press upwards, the blade set will detach from the device.
- Brush the accumulated hair from the blades.
- To replace the blade, make sure the blade is aligned and the grooves on the blade cartridge match up with slots in the housings.
- Push the blade into the housing until it snaps into place.

REMOVING THE RECHARGEABLE BATTERY

This appliance contains batteries that are non-replaceable. When the battery is at the end of its life, the appliance and battery must be properly disposed of at an official recycling point.

We strongly recommend that a professional removes the rechargeable battery. Parts of the shaver case, and tools have sharp edges and may cause injury if not handled correctly.

- The battery must be removed from the appliance before it is scrapped.
 - Disconnect the charging adapter before removing the battery.
 - Be aware of the risk of terminals of the battery-operated appliance or battery being short circuited by metal objects.
1. Ensure that the battery is fully discharged. To do this, operate the device until it stops.
 2. Remove the comb and trimmer head.

3. Unscrew the 2 screws from the unit top.
 4. Unscrew the 2 screws from the bottom housing.
 5. Open the front housing to expose the batteries.
 6. Take out the battery and cut the two wires on the end of the battery.
- Used batteries must be removed from the appliance and disposed of at an appropriate official recycling/collection point.
 - Do not attempt to operate the device once you have opened it.

PRECISION TRIMMER, AND NOSE AND EAR TRIMMER

INSERTING BATTERIES

- Both trimmers require 1 'AA' alkaline battery (first one included).
- Ensure the product is switched off.
- To open the battery compartment, turn the base of the unit approximately 1cm counter-clockwise and pull it off.
- Insert the battery into the unit, positive end first.
- Replace the base and turn it 1cm clockwise to lock it into place.

Note: Your trimmer will not work if the batteries are inserted incorrectly.

INSTRUCTIONS FOR USE

Note: Do not apply excessive pressure as this damages the trimmer head and may cause skin injury.

TO REMOVE HAIR FROM NOSE

- Select the nose and ear trimmer.
- Insert it gently into the nostril.
- Gently move it in and out of your nostril and at the same time rotate it.
- Avoid inserting the cutting unit more than 6mm into your nostril.

TO TRIM SIDEBURNS

- Select the precision trimmer.
- Gently guide the cutting unit to your sideburns holding the unit horizontally at a 90 degree angle to the sideburns.
- Trim the sideburns moving the trimmer slowly and carefully, to ensure that you do not accidentally cut hairs that you do not intend to trim.
- Note: It is not recommended that you use the trimmer to define or trim the eyebrows.

TO REMOVE HAIR FROM EAR

- Select the nose and ear trimmer.
- Insert the cutting unit gently into the outer ear canal opening.
- Gently rotate the trimmer in a circular motion.
- Avoid inserting the cutting unit more than 6mm into your ear canal.

CARE FOR YOUR TRIMMER

- Care for your product to ensure a long lasting performance. We recommend that you clean it after each use.
- For best results, keep trimmer running while rinsing it under the tap.
- Dry off excess water.
- Do not submerge in water as damage will occur.

TROUBLESHOOTING

- The trimmer is not running but has battery power left:
- If the trimmer is not running it may need cleaning; look for and remove any dried debris from the cutting blades.

AFTER EACH USE

- Rinse the accumulated hair from the cutters as noted above. Ensure all debris is removed from between the blades and shake off excess water.

BATTERY REMOVAL

- The battery must be removed from the appliance before it is scrapped.
- Rotate the battery compartment cap approximately ¼ turn anti-clockwise then pull off.
- Remove the battery from the battery compartment.
- Place the cap back on the unit opposite to how it came off and rotate clockwise until the cap snaps into place.
- The battery is to be disposed of safely.

RECYCLING



To avoid environmental and health problems due to hazardous substances, appliances and rechargeable and non-rechargeable batteries marked with one of these symbols must not be disposed of with unsorted municipal waste. Always dispose of electrical and electronic products and, where applicable, rechargeable and non-rechargeable batteries, at an appropriate official recycling/ collection point.

SERVICE AND GUARANTEE



Defects affecting product functionality appearing within the guarantee period will be corrected by replacement or repair at our option provided the product is used and maintained in accordance with the instructions. Your statutory rights are not affected.

This warranty shall not be valid where it is contrary to U.S. and other applicable laws, or where the warranty would be prohibited under any economic sanctions, export control laws, embargos, or other restrictive trade measures enforced by the United States or other applicable jurisdictions. This includes, without limitation, any warranty claims implicating parties from, or otherwise located in, Cuba, Iran, North Korea, Syria and the Crimea region.

To claim an extra 1 year guarantee, register your product online within 28 days of purchase.

Register at: <https://uk.remington-europe.com/product-registration>

Consumables are guaranteed only for their recommended lifecycle. Replacement/spare parts* are excluded and are only covered by a 1 year warranty.

*Examples include, but are not limited to, adaptors, haircare attachments, grooming accessories, etc.

SERVICE CENTRE

UNITED KINGDOM

 0800 212 438 (free call mainland UK)

Spectrum Brands (UK) Ltd
Fir Street, Failsworth, Manchester
M35 0HS, UK

www.remington.co.uk
productsupport@Remington.co.uk

IRELAND

 142 951 40

Remington Consumer Products,
Unit B12, Ballymount Corporate Park,
Ballymount, Dublin 12

<https://ie.remington-europe.com>
productsupport@Remington.co.uk

REMINGTON®
EST. NEW YORK 1937

